

TECHNICAL SPECIFICATIONS

Material: Polyamide PA66
 Copper
 Current / Voltage: 16A / 500V
 Working temperature: -40°C to +130°C
 Positions: 2, 3, 4, 5
 Colour: White or Black

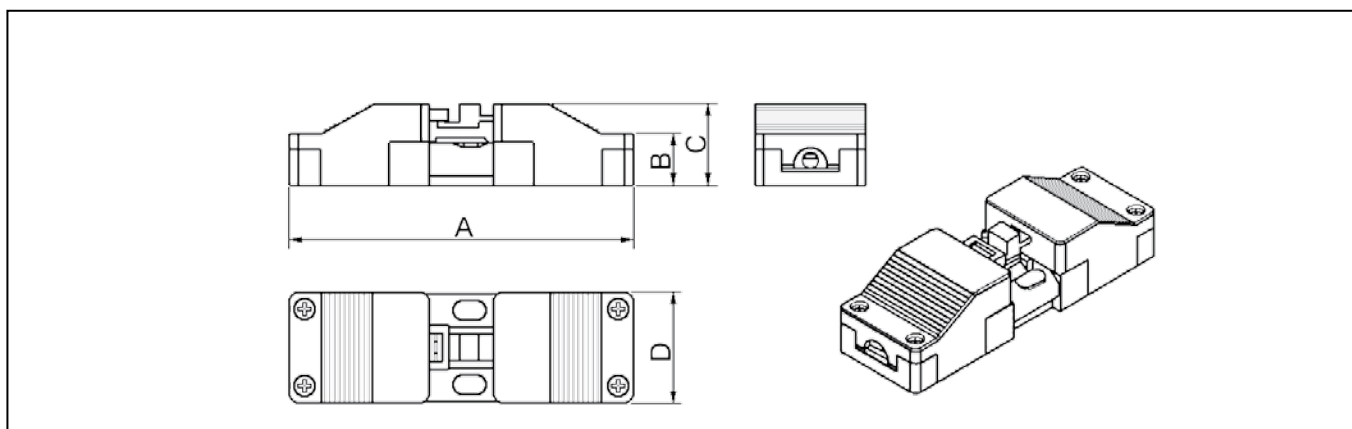

CE and RoHS approved



Size	A	B	C	D
2-pos	91,5	14	21,5	19,5
3-pos	91,5	14	21,5	29,5
4-pos	111,5	17,5	24,5	38,5
5-pos	105,5	18,0	28,0	50,0

Order Codes:

Part No:	Description:	Color:	Package / Note:
7600-0003-02	Armature Connector - 2 pos, Male + Female	White	Kit
7600-0003-03	Armature Connector - 3 pos, Male + Female	White	Kit
7600-0003-04	Armature Connector - 4 pos, Male + Female	White	Kit
7600-0003-05	Armature Connector - 5 pos, Male + Female	White	Kit
7600-1003-02	Armature Connector - 2 pos, Male + Female	Black	Kit
7600-1003-03	Armature Connector - 3 pos, Male + Female	Black	Kit
7600-1003-04	Armature Connector - 4 pos, Male + Female	Black	Kit
7600-1003-05	Armature Connector - 5 pos, Male + Female	Black	Kit

