

**Series:** I2SS / T2I 2,00 mm (.0787") Single Row Discrete Wire IDC System Cable Assembly Housing, Socket / Terminal Strip

**I2SS Series – Cable Assembly Housing, Socket**

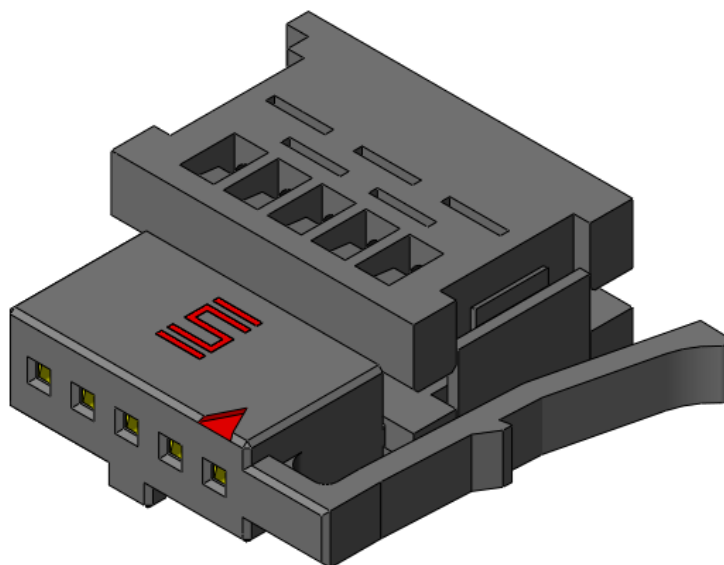

**T2I Series – Terminal Strip**

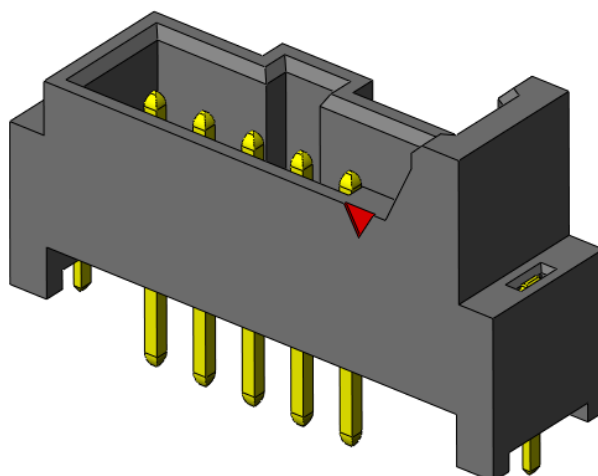

See [www.samtec.com](http://www.samtec.com) for more information.

**Series:** I2SS / T2I 2,00 mm (.0787") Single Row Discrete Wire IDC System Cable Assembly Housing, Socket / Terminal Strip

## 1.0 SCOPE

- 1.1** This specification covers performance, testing and quality requirements for Samtec's I2SS/T2I Series 2,00mm (.0787") Single Row Discrete Wire IDC system Cable Assembly Housing, Socket and Terminal Strip Connectors. All information contained in this specification is for a 5 positions configuration unless otherwise noted.

## 2.0 DETAILED INFORMATION

- 2.1** Product prints, footprints, catalog pages, test reports and other specific, detailed information can be found at [www.samtec.com?I2SS](http://www.samtec.com?I2SS) and [www.samtec.com?T2I](http://www.samtec.com?T2I).

## 3.0 TESTING

- 3.1 Current Rating:** 4.7 A (One Pin Powered)  
**3.2 Voltage Rating:** 250 VAC  
**3.3 Operating Temperature Range:** -55°C to +105°C (Connector Only, Wire used may decrease the operating temperature range)  
**3.4 Operating Humidity Range:** 90% to 95% (Per EIA-364-31)  
**3.5 Electrical:**

ITEM	TEST CONDITION	REQUIREMENT	STATUS
Withstanding Voltage	EIA-364-20 (No Flashover, Sparkover, or Breakdown)	750 VAC	Pass
Insulation Resistance	EIA-364-21 (1000 MΩ minimum)	1,000 MΩ	Pass
Contact Resistance (LLCR)	EIA-364-23	Δ 15 mΩ maximum (Samtec defined)/ No damage	Pass

## 3.6 Mechanical:

ITEM	TEST CONDITION	REQUIREMENT	STATUS
Durability	EIA-364-09C	100 cycles	Pass
Random Vibration	EIA-364-28 Condition V, Letter B 7.56 G 'RMS', 50 to 2000 Hz, 2 hours per axis, 3 axis total, PSD 0.04	Visual Inspection: No Damage LLCR: Δ 15 mΩ maximum	Pass
Mechanical Shock	EIA-364-27 100 G, 6 milliseconds, sawtooth wave, 11.3 fps, 3 shocks/direction, 3 axis (18 total shocks)	Visual Inspection: No Damage LLCR: Δ 15 mΩ maximum	Pass
Normal Force	EIA-364-04	30 grams minimum for gold interface	Pass

**Series:** I2SS / T2I 2,00 mm (.0787") Single Row Discrete Wire IDC System Cable Assembly Housing, Socket / Terminal Strip

### 3.7 Environmental:

ITEM	TEST CONDITION	REQUIREMENT	STATUS
Thermal Shock	EIA-364-32 Thermal Cycles: 100 (30 minute dwell) Hot Temp: +85°C Cold Temp: -55°C Hot/Cold Transition: Immediate	Visual Inspection: No Damage LLCR: $\Delta$ 15 m $\Omega$ DWV: 750 VAC IR: >1,000 M $\Omega$	Pass
Thermal Aging (Temp Life)	EIA-364-17 Test Condition 4 @ 105°C Condition B for 250 hours	Visual Inspection: No Damage LLCR: $\Delta$ 15 m $\Omega$ DWV: 750 VAC IR: >1,000 M $\Omega$	Pass
Cyclic Humidity	EIA-364-31 Test Temp: +25°C to +65°C Relative Humidity: 90 to 95% Test Duration: 240 hours	Visual Inspection: No Damage LLCR: $\Delta$ 15 m $\Omega$ DWV: 750 VAC IR: >1,000 M $\Omega$	Pass
Gas Tight	EIA-364-36 Gas Exposure: Nitric Acid Vapor Duration: 60 min. Drying Temp.: 50°C +/- 3°C Measurements: Within 1 hour of Exposure	LLCR: $\Delta$ 15 m $\Omega$	Pass

**Series:** I2SS / T2I 2,00 mm (.0787") Single Row Discrete Wire IDC System Cable Assembly Housing, Socket / Terminal Strip

#### 4.0 MATED SYSTEM

Mated view information can be found at link below:

<http://www.samtec.com/documents/webfiles/cpdf/I2SS-T2I%20MATED%20DOCUMENT-MKT.pdf>

#### 5.0 POLARIZING FEATURES

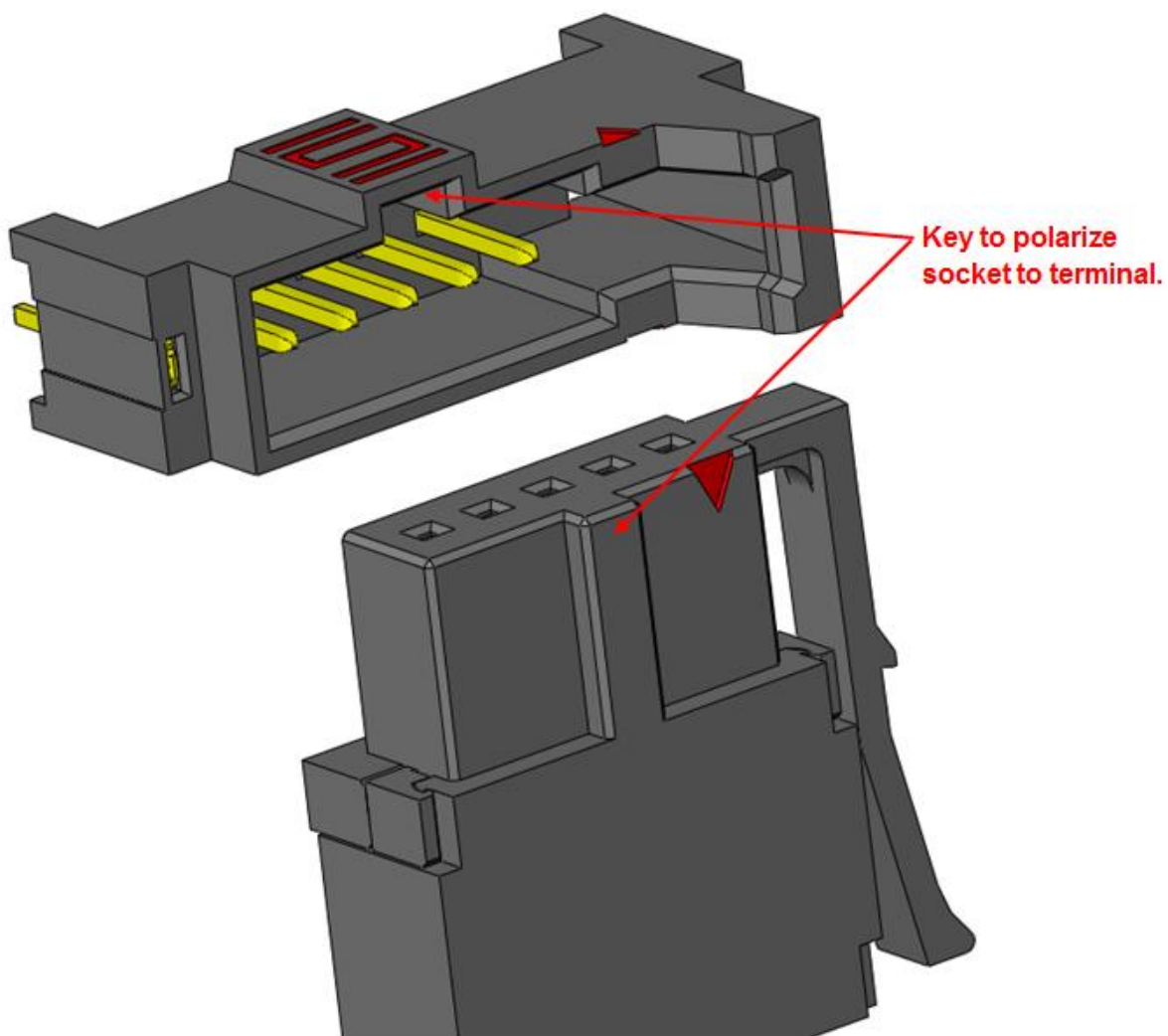

**Series:** I2SS / T2I 2,00 mm (.0787") Single Row Discrete Wire IDC System Cable Assembly Housing, Socket / Terminal Strip

**6.0 LATCH FEATURES:** To disengage cable from socket, first, fully seat connector; second fully depress latch release and third, pull straight back with latch released depressed.

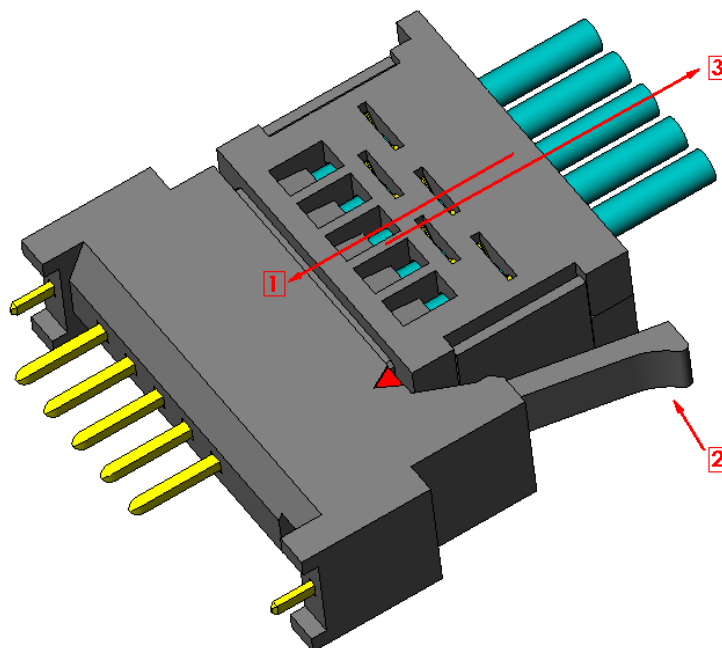

## 7.0 PROCESSING RECOMMENDATIONS

**7.1 Mating Angle Requirements:** Cable must be axially aligned to connector when mated and un-mated.

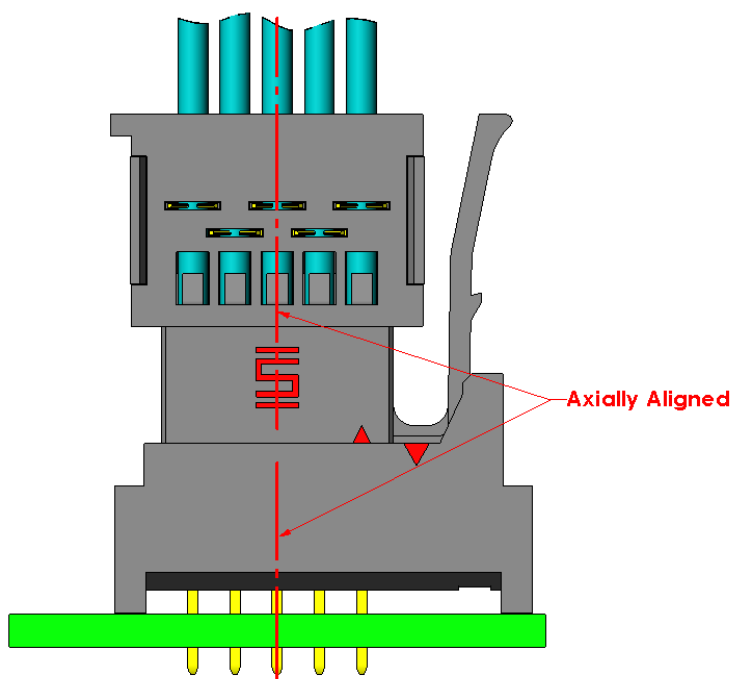

7.1.1

**Series:** I2SS / T2I 2,00 mm (.0787") Single Row Discrete Wire IDC System Cable Assembly Housing, Socket / Terminal Strip

## 8.0 APPLICATION

8.1 Insert cables into I2SS assembly.

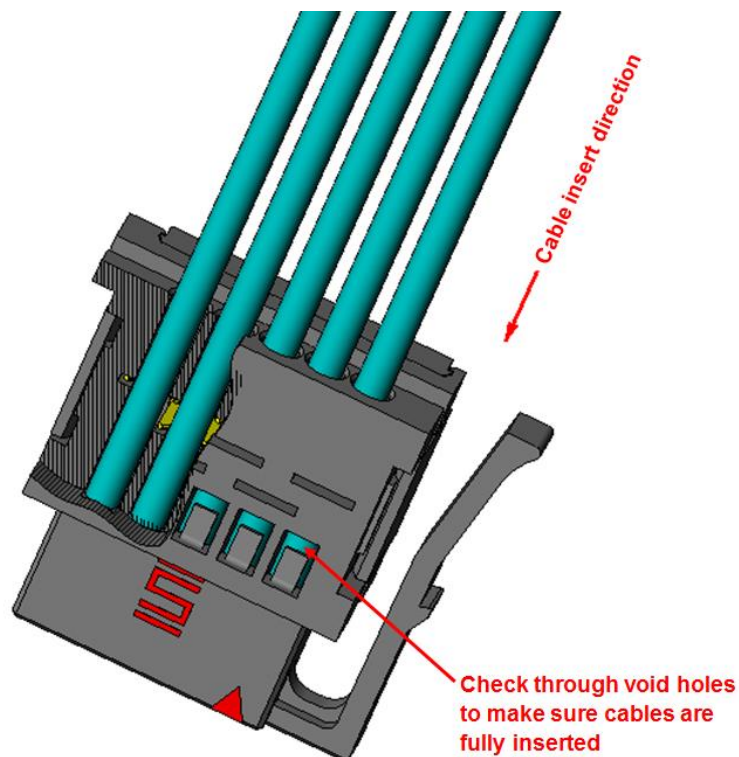

8.1.1

8.2 Press I2SS with Plier.

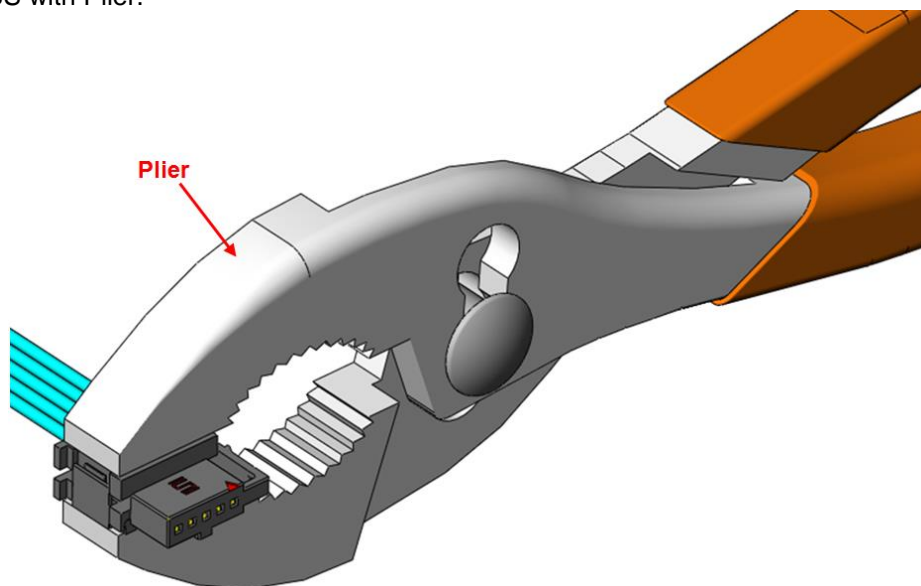

8.2.1

**Series:** **I2SS / T2I** 2,00 mm (.0787") Single Row Discrete Wire IDC System Cable Assembly Housing, Socket / Terminal Strip

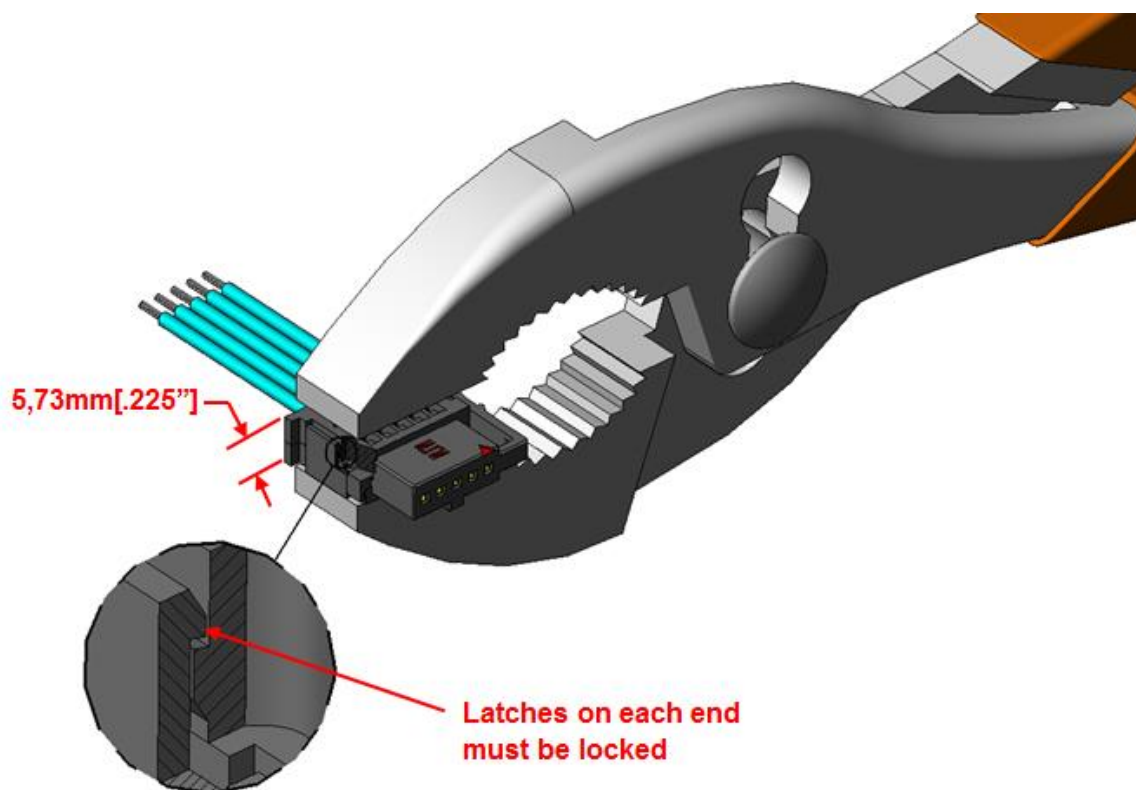

#### 8.2.2

### 9.0 ADDITIONAL RESOURCES

- 9.1 For additional mechanical testing or product information, contact our Customer Engineering Support Group at [CES@samtec.com](mailto:CES@samtec.com)
- 9.2 For additional information on high speed performance testing, contact our Signal Integrity Group at [SIG@samtec.com](mailto:SIG@samtec.com)
- 9.3 For additional processing information, contact our Interconnect Processing Group at [IPG@samtec.com](mailto:IPG@samtec.com).
- 9.4 For RoHS, REACH or other environmental compliance information, contact our Product Environmental Compliance Group at [PEC@samtec.com](mailto:PEC@samtec.com)



**Series:** **I2SS / T2I** 2,00 mm (.0787") Single Row Discrete Wire IDC System Cable Assembly Housing, Socket / Terminal Strip

### USE OF PRODUCT SPECIFICATION SHEET

This Product Specification Sheet ("PSS") is a brief summary of information related to the Product identified. As a summary, it should only be used for the limited purpose of considering the purchase/use of Product. For specific, detailed information, including but not limited to testing and Product footprint, refer to Section 2.0 of this document and the links there provided to test reports and prints. This PSS is the property of Samtec, Inc. ("Samtec") and contains proprietary information of Samtec, our various licensors, or both. Samtec does not grant express or implied rights or license under any patent, copyright, trademark or other proprietary rights and the use of the PSS for building, reverse engineering or replication is strictly prohibited. By using the PSS, the user agrees to not infringe, directly or indirectly, upon any intellectual property rights of Samtec and acknowledges that Samtec, our various licensors, or both own all intellectual property therein. The PSS is presented "AS IS". While Samtec makes every effort to present excellent information, the PSS is only provided as a guideline and does not, therefore, warrant it is without error or defect or that the PSS contains all necessary and/or relevant information about the Product. The user agrees that all access and use of the PSS is at its own risk. **NO WARRANTIES EXPRESSED OR IMPLIED, INCLUDING ANY WARRANTY OF MERCHANTABILITY, FITNESS FOR A PARTICULAR PURPOSE OR OF ANY KIND WHATSOEVER ARE PROVIDED.**