

EEL-LDH-AC-FER

Infrared remote control set



GENERAL

INTENDED USE

The EEL-LDH-AC-FER must be used with Bansbach® control boxes. The control box must be installed, initially operated and functional tested by competent personnel only. Use other than described above is only allowed with permission of Bansbach®.

Information: For all information concerning Bansbach® control boxes please refer to the corresponding manual.

DEFINITION

Aside of moving your table up and down your Bansbach® control box is able to carry out other functions, like controlling the brightness of a lamp or a monitor – height adjustment. This function is called second motor group.

PACKAGE CONTENTS

- | | |
|---------------------|--|
| ① IR remote control | ③ Adhesive disk for mounting the IR receiver |
| ② IR receiver | ④ 2xAAA batteries |



FEATURES

- Cable-free operation
- Control of 2 motor groups
- 2 infrared channels
- 2 memory positions



Danger: Use only genuine replacement parts! Repairs must be carried out only by a qualified service technician! If you neglect to do so you void your warranty!

OVERVIEW

Buttons on the remote control

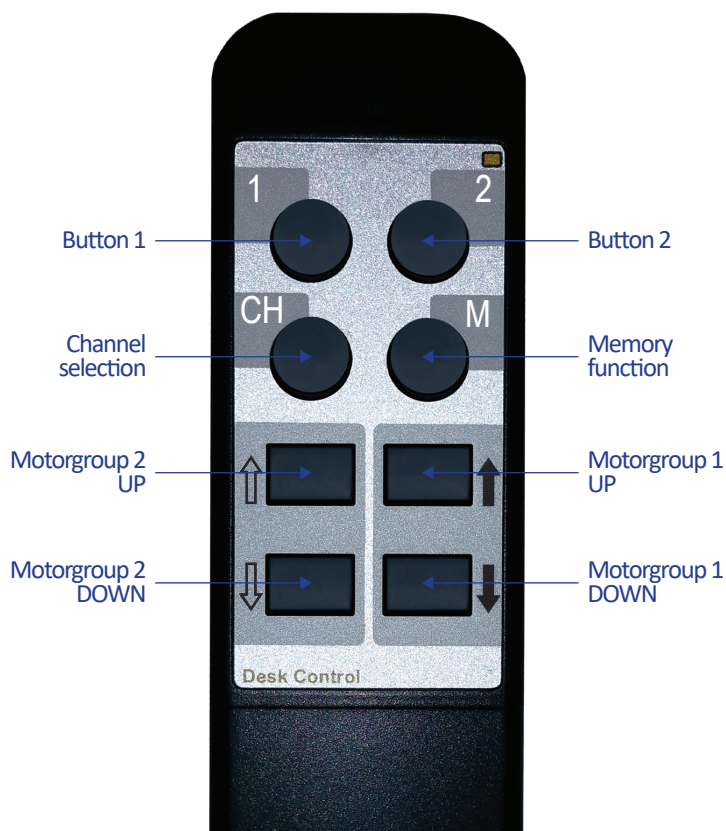

TYPE & DIMENSIONS

Tolerances according to DIN ISO 2768-1 c

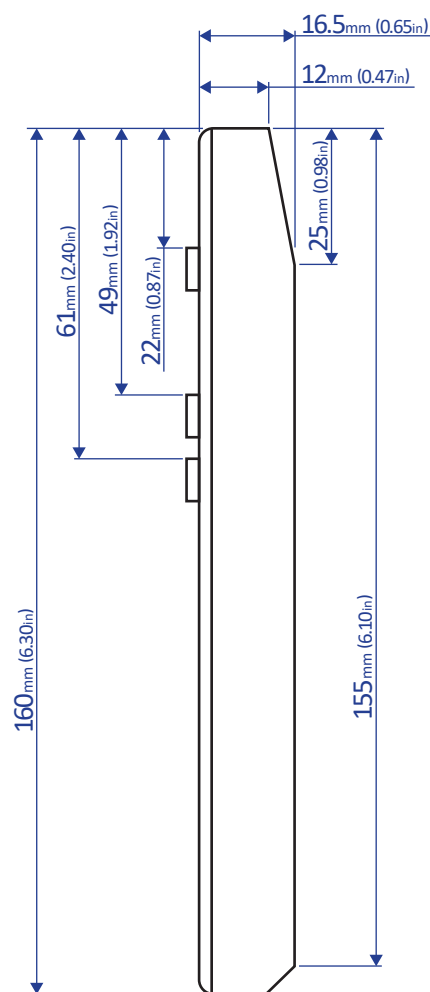

MOUNTING INSTRUCTIONS

Mount the IR-receiver underside your desktop in an appropriate position. Use the adhesive disk.

1. Unpack the IR-receiver and the IR remote control.



Note: Dispose of the packaging material ecologically sound (separate plastic foil and cardboard)!

2. Put the batteries into the IR remote control.



Caution: Be aware of the correct polarity of the batteries!

3. Place the IR-receiver on the underside of your desktop on the position of choice. Its front side should not protrude over the table's edge.

4. Connect the IR-receiver to the control box using the jack marked with **HS** only! Do not connect the handswitch plug to the motor jacks!





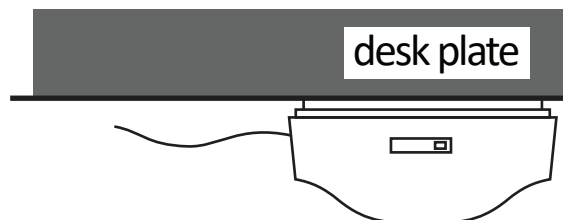

Caution: Unplug the power cord of the control unit while mounting the handswitch!



The infrared receiver can be mounted with an adhesive disk underneath the desktop

FUNCTIONS

FUNCTION	DESCRIPTION	NOTE
Desk upwards 	For an upward adjustment of the desk push this button. Push this button until the desired height of the desk has been reached.	The desk will continue driving upwards until you release the button, or the maximum height is reached.
Desk downwards 	For a downward adjustment of the desk push this button. Push this button until the desired height of the desk has been reached.	The desk will continue driving upwards until you release the button, or the maximum height is reached.
Motor group 2 / Desk upwards 	For an upward adjustment of the motor group 2 (e.g. monitor adjustment) or desk, push this button. Push this button until the desired height of the desk has been reached.	In case of no motor group 2 attached this button is used for the Desk upwards function. Motor group 2 will continue driving upwards until you release the button, or the maximum height is reached.
Motor group 2 / Desk downwards 	For a downward adjustment of the motor group 2 (e.g. monitor adjustment) or desk, push this button. Push this button until the desired height of the desk has been reached.	In case of no motor group 2 attached this button is used for the Desk downwards function. Motor group 2 will continue driving downwards until you release the button, or the maximum height is reached.



Note: In case of no motor group 2 attached the therefore assigned buttons (motor group 2 upwards / motor group 2 downwards) are used for the desk upwards / desk downwards functions.

ADVANCED FUNCTIONS

STORING A POSITION — Using this function you are able to store a desk-height.



Note: On initial operation all stored positions are equal to the lowest possible desk-height (lower end position). Only 1 desk height per button is allowed.



Move the desk to the position you want to store.
Press the **memory** button



Press the position button of choice (e.g. 1).

Now the height is stored on the chosen position button. You hear a double click of the control unit.

RECALLING A STORED POSITION — Using this function you are able to recall a stored position.

Press the position button of choice (e.g. 1).



The desk moves until the saved position is reached. If you release the button before reaching the saved position, the desk stops and the saved position will not be reached.

The desk has reached the saved height. Release the position button.

TECHNICAL DATA

Tolerances according to DIN ISO 2768-1 c

GENERAL	
Supply voltage	5 VDC \pm 10%
Current consumption	0 mA
Rated switching current	50 mA
Life cycle (switching cycles)	10,000 cycles
Ambient temperature	0 - 50°C
Cable length	1800 mm \pm 50mm
Dimensions (l x w x h)	54.8mm x 66.7 mm x 17mm without mounting plate
Weight (including cable)	0.06kg



Note: The foil of the handswitch might perish or might grow pale due to intensive UV radiation. Therefore avoid direct solar radiation!

POSSIBLE ERRORS AND SOLUTIONS

DISPLAY DOES NOT WORK	
Possible cause	Solution
Cable is defect	Contact our customer service
Display is defect	Contact our customer service / change the handswitch
Microcontroller is defect	Contact our customer service / change the handswitch
Handswitch is defect	Contact our customer service / change the handswitch
BUTTONS DO NOT WORK (display works)	
Possible cause	Solution
Cable is defect	Contact our customer service
Handswitch is defect	Contact our customer service / change the handswitch
HANDSWITCH DOES NOT WORK (neither display nor buttons)	
Possible cause	Solution
Cable is not plugged	Plug the plug in the intended jack marked with  .
Cable is not plugged as intended	
Bad pin contact	Plug off the plug and plug it in as intended (as described above)
Cable is defect	Contact our customer service

FINAL DISPOSAL

Please heed following disposal instructions when disposing of the HSF-cablehandswitch:



Note: Dispose of the components ecologically sound (separate plastic from electronics parts)!

COMPATIBILITY

The HSU handswitch is compatible to following easyE® controllers:

- EEL-S1

ORDER CODE

- EEL-LDH-AC-FER

Bansbach Easylift®

50 West Drive
Melbourne, FL 32904

Tel: (321) 253-1999
Fax: (321) 253-5546

sales@easylift.com
www.easylift.com



The brochure is subject to technical alterations and printing mistakes.

06/2020

HANDSWITCH PLUG

Pin assignment

Handswitch connector
on the infrared receiver

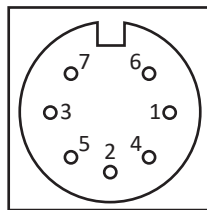

1	HS1
2	HS3
3	RxD
4	HS2
n.c.	not connected

5	HS4
6	+5V
7	TxD
Shell	GND

(pin alignment according to DIN 45329)



Caution: The EEL-LDH-AC-FER is only suitable for Bansbach® motor controls.
To prevent damage of the unit, take care not to interchange handswitch and motor sockets.

Colour code:

Handswitch: blue
Motor: black

CHANNEL SELECTION

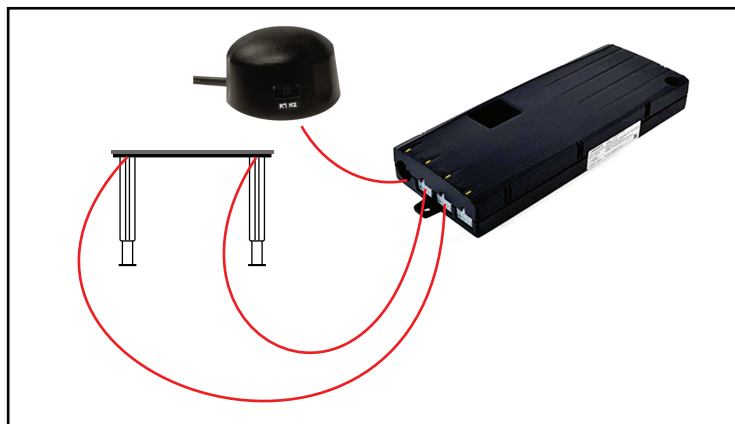

Connect the HSF cable-handswitch to the control box (e.g. COMPACT)

The handset allows operation on two channels, i.e. two control boxes can be operated with one handset independently. Basically, an arbitrary number of receivers can be operated with one handset.

Channel Selection (Handset):

Press button „CH“ for 5 seconds, then press button „1“ or „2“ shortly for the respective channel.

Channel Selection (Receiver):

If the switch on the receiver is in its left position, channel 1 is selected, in the middle or right position channel 2 is selected.



Left position (channel 1)

Right position (channel 2)