

RoHS Compliant

REV	SIGN	DATE	DESCRIPTION	APPROVER
A0		2021.09.16	Initial Release	LENA
THIS IS CAD DRAWING, DO NOT REVISE MANUALLY!!!				

#### COIL SPECIFICATION

- Coil Nominal Voltage: 5V DC
- Coil Nominal Current: 71.4mA
- Coil Resistance:  $70\Omega \pm 10\%$
- Coil Power Consumption: Abt. 0.36W
- Pull-In Voltage(VDC): 4.0V Max
- Drop-Out Voltage(VDC): 0.25V Min
- Maximum Allowable Voltage: 5.5V
- Operate Time: 10 mSec. Max.
- Release Time: 5 mSec. Max.

#### CONTACT RATING

- Rated Load(Resistive): 16A 277V AC, 16A 24VAC
- Rated Carrying Current: 16A
- Max. Allowable Voltage: AC 277V / DC 24V
- Max. Allowable Current: 16A
- Max. Allowable Power Force: 4,432VA 384W
- Contact Material: Ag Alloy
- Contact Form: SPST

#### ELECTRICAL

- Dielectric Strength:
  - Between Coil & Contact: 4,000V AC (50/60 Hz for 1 minute)
  - Between Contact: 1,000V AC (50/60 Hz for 1 minute)
- Contact Resistance: 100m $\Omega$  Max. at 1A, 6V DC
- Insulation Resistance: 100M $\Omega$  Min at 500V DC

#### MECHANICAL

- Life Expectancy(Operations):
  - Electrical:  $1 \times 10^6$  operations at Rated Resistive load
  - Mechanical:  $1 \times 10^7$  operations at No Resistive load
- Operating Temperature: -40°C ~ 105°C
- Safety Approval: UL

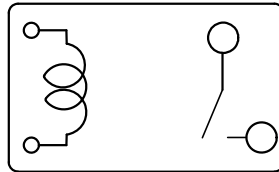
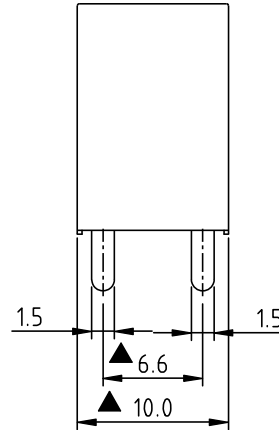
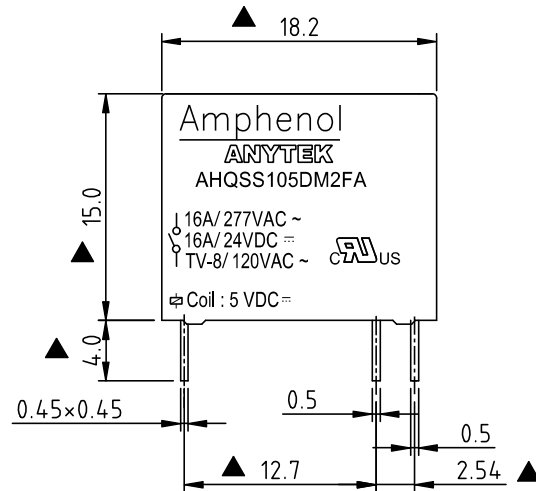

Part No. AHQ SS 1 05 D M 2 F A0G

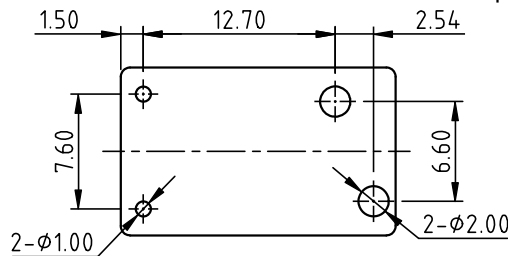

P.C.B. LAYOUT  
Bottom View

- Insulation System:
  - F : Class F
- Rated Carrying Current:
  - 2 : 16A
- Contact Form:
  - M : One Form A
- Coil Type:
  - D : Standard DC Coil
- Coil Voltage:
  - 12: 5V(VDC)
- Number of pole,
  - 1: One Pole
- Type of sealing :
  - SS:RT II Flux Proofed
- TYPE : AHQ

**Amphenol**  
**ANYTEK**

#### CUSTOMER COPY

ALL RIGHTS RESERVED. REPRODUCTION OR ISSUE TO THIRD PARTIES IN ANY FORM WHATEVER IS NOT PERMITTED WITHOUT WRITTEN AUTHORITY FROM THE PROPRIETOR. PROPERTY OF ANYTEK TECHNOLOGY CO., LTD

TITLE		AHQ Series Relay, one pole, 5V DC, RT II Wash Tight							
PART NO.		AHQSS105DM2FA0G			DWG NO.		8AHQ0008		
APPROVED		CHECKED	DESIGNED	DRAWN	CUST NO.		Tolerance		
			LENA 2021.09.16	LENA 2021.09.16			UNIT: mm	X.	±0.50
							SCALE: 2:1	X.X	±0.30
					SHEET: 01/01		REV.: A0	X.XX	±0.10
								X°	±1°