

REV	DESCRIPTION	DATE	REV BY
A	INITIAL DRAWING RELEASE	8/15/2023	CNH

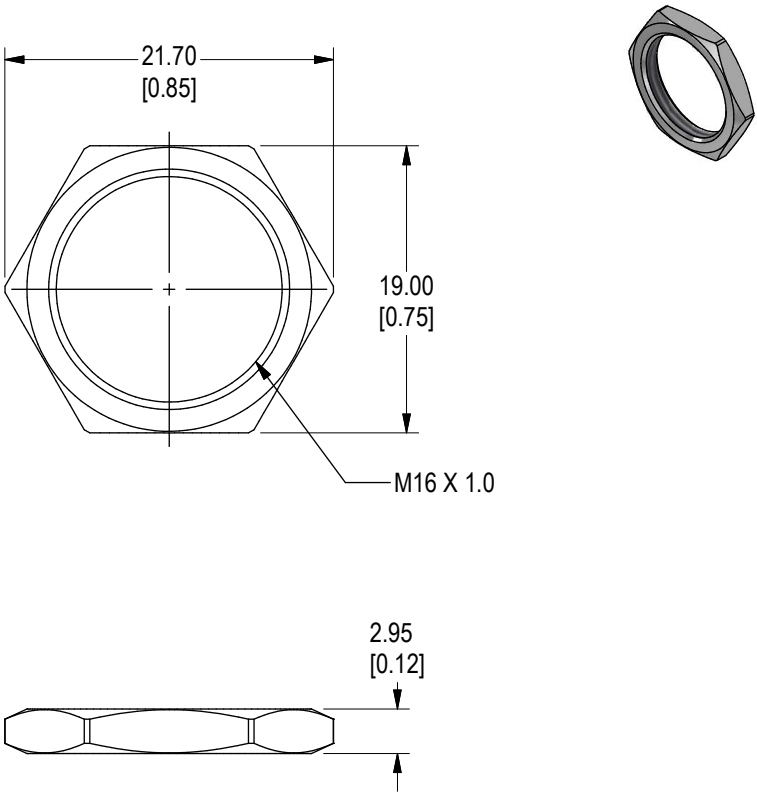

**SPECIFICATIONS & MATERIALS**

1. Material: Nickel plated brass
2. For use with CIT CH series switches
3. RoHS3 2015/863/EU Compliant

<div> <div>CIT</div> <div>RELAY &amp; SWITCH™</div> <div>Division of Circuit Interruption Technology, Inc.</div> </div>		
<div> <div>TITLE</div> <div>16mm HEX NUT FOR CH SERIES SWITCHES</div> </div>		
<div> <div>SIZE</div> <div>A</div> </div>	<div> <div>PART NO.</div> <div>CH16HEXNUT</div> </div>	<div> <div>REV.</div> <div>A</div> </div>

**PROPRIETARY NOTICE**  
 THIS DOCUMENT IS THE SOLE PROPERTY OF CIT RELAY & SWITCH AND IS NOT TO BE DISCLOSED, REPRODUCED IN WHOLE OR IN PART, OR USED FOR ANY MANUFACTURING PURPOSES BY ANYONE WITHOUT THE EXPRESS WRITTEN CONSENT OF CIT RELAY & SWITCH.

DIMENSIONS: mm (in.)  
 UNSPECIFIED TOLERANCES  
 FRAC.± 1/64 X.XXX ± 0.127(0.005)  
 X.XX ± 0.25(0.01) ANGLES ± 1°

DRAWN	CNH	DATE	8/15/2023
SCALE	2 : 1	SHT	1 of 1