

PART NO.	A79288-001	REV	ECO	DATE	APP
		D	101657	05-28-15	TLM

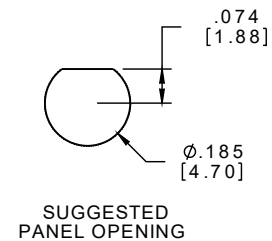
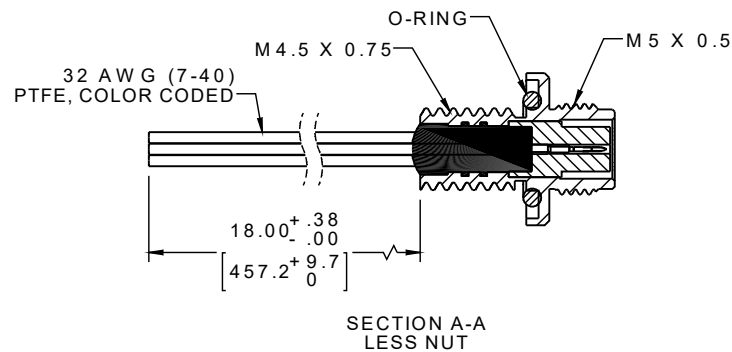
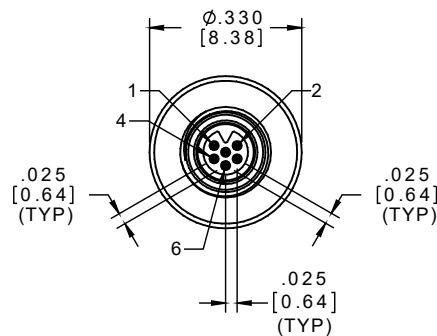
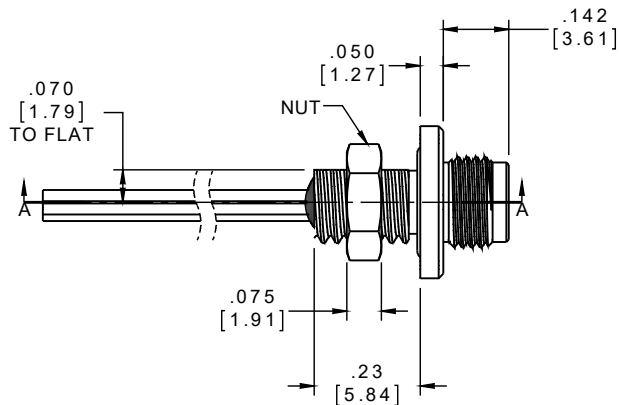

PIN #	COLOR
1	BLACK
2	BROWN
3	RED
4	ORANGE
5	YELLOW
6	GREEN

INTERNAL USE ONLY
USE MFG LOADING
PROCEDURE NC-6P

IP68

NOTE:

DIMENSIONS IN [] ARE IN
MILLIMETERS UNLESS
OTHERWISE NOTED AND ARE
FOR REFERENCE ONLY

MNCIP	SLDW	THIRD ANGLE	THIS DRAWING CONTAINS CONFIDENTIAL AND PROPRIETARY INFORMATION WHICH IS THE PROPERTY OF OMNETICS CONNECTOR CORP. THIS DOCUMENT MAY NOT, IN WHOLE OR IN PART, BE DUPLICATED, OR DISCLOSED FOR ANY PURPOSE, WITHOUT WRITTEN PERMISSION FROM OMNETICS CONNECTOR CORP.		
		-TOLERANCES-	DFTM. NJS	DATE	TITLE:
		UNLESS OTHERWISE NOTED			(6) PIN MALE NANO
		DIMENSIONS IN INCHES			THREADED PANEL MOUNT
		2 PL DEC ± .01	CHK'D.	DATE	SEALED CIRCULAR CONNECTOR
		3 PL DEC ± .005			
		4 PL DEC ± .0005	APP'D.	DATE	
		ANGLES ± 1°			

OMNETICS
CONNECTOR CORPORATION
7260 COMMERCE CIRCLE EAST
MINNEAPOLIS, MN 55432
WWW.OMNETICS.COM

CAGE CODE 61873	REV
DWG NO. A79288-001	D
SHEET 1 OF 2	
SCALE: 3:1	