



PRODUCT BULLETIN

CUSTOMER NAME	ALL CUSTOMERS		
MODEL AFFECTED	VLM100-60-40 SERIES		
PROCESS CHANGE ORDER	PB20190115005	IMPLEMENTATION DATE	2/12/2019
DESCRIPTION OF CHANGE: VLM Series Case Dimension Change			

CUSTOMER CONTACT	SaveEnergy@erp-power.com
DATE OF NOTIFICATION	1/15/2019

The [VLM Series](#) LED Drivers from ERP Power are being produced as of February 2019 with a slightly modified case design as depicted below. The original case material was extruded aluminum. The new case material is sheet metal aluminum (stamped vs. extruded). The summary of changes are:

VLM100

- Overall footprint **length** remains the same at 151 mm
- Overall footprint **width** is 0.2 mm smaller at the bottom (26 mm whereas previously 26.2 mm), the top of the unit is 1.1 mm larger (27.3 mm whereas previously 26.2 mm)
- Overall footprint **height** is 0.05 mm smaller (19.8 mm whereas previously 19.85 mm)
- Calculated lifetime remains greater than 50,000 hours at case temperature of 70°C for both 120Vac and 277Vac input

VLM100-S

- Overall footprint **length** remains the same at 137 mm
- Overall footprint **width** is 0.2 mm smaller at the bottom (26 mm whereas previously 26.2 mm), the top of the unit is 1.1 mm larger (27.3 mm whereas previously 26.2 mm)
- Overall footprint **height** remains the same at 23.85 mm
- Calculated lifetime remains greater than 50,000 hours at case temperature of 70°C for both 120Vac and 277Vac input

VLM100-T

- Overall footprint **length** remains the same at 208.6 mm
- Overall footprint **width** is 0.2 mm smaller at the bottom (26 mm whereas previously 26.2 mm), the top of the unit is 1.15 mm larger (27.35 mm whereas previously 26.2 mm)
- Overall footprint **height** remains the same at 19.85 mm
- Calculated lifetime remains greater than 50,000 hours at case temperature of 70°C for both 120Vac and 277Vac input

VLM60 / VLM40

- Overall footprint **length** remains the same at 144 mm
- Overall footprint **width** is 0.2 mm smaller at the bottom (19.65 mm whereas previously 19.85 mm), the top of the unit is 1.1 mm larger (20.95 mm whereas previously 19.85 mm)
- Overall footprint **height** is 0.05 mm smaller (19.8 mm whereas previously 19.85 mm)
- Calculated lifetime remains greater than 50,000 hours at case temperature of 70°C for both 120Vac and 277Vac input

VLM60-S / VLM40-S

- Overall footprint **length** remains the same at 130 mm
- Overall footprint **width** is 0.2 mm smaller at the bottom (19.65 mm whereas previously 19.85 mm), the top of the unit is 1.1 mm larger (20.95 mm whereas previously 19.85 mm)
- Overall footprint **height** remains the same at 23.85 mm
- Calculated lifetime remains greater than 50,000 hours at case temperature of 70°C for both 120Vac and 277Vac input

VLM60-T / VLM40-T

- Overall footprint **length** remains the same at 198.6 mm
- Overall footprint **width** is 0.2 mm smaller at the bottom (19.65 mm whereas previously 19.85 mm), the top of the unit is 1.15 mm larger (21 mm whereas previously 19.85 mm)
- Overall footprint **height** remains the same at 19.85 mm
- Calculated lifetime remains greater than 50,000 hours at case temperature of 70°C for both 120Vac and 277Vac input

Contact your ERP representative at +1 805-517-1300 or email SaveEnergy@erp-power.com with any questions.

NEW VLM100 Sheet Metal Aluminum Case

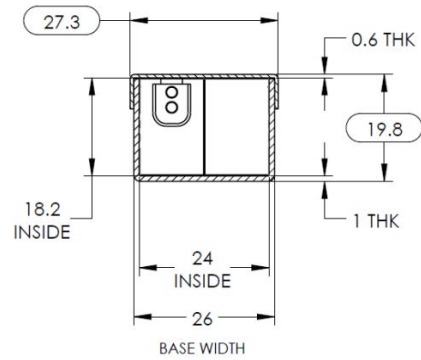
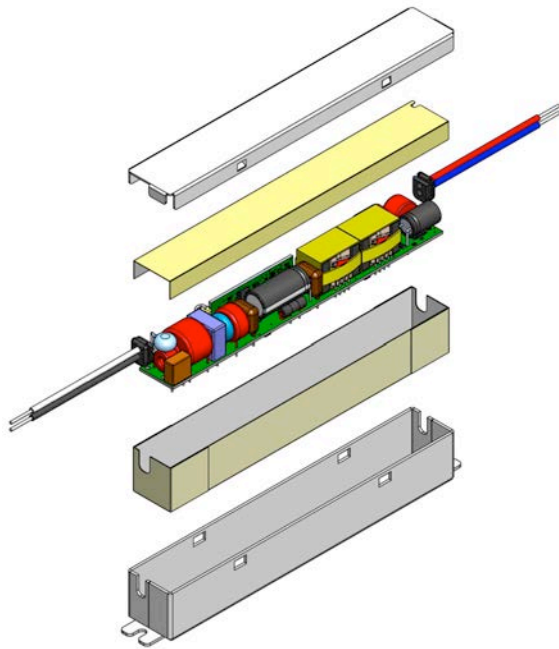

PREVIOUS VLM100 Extruded Aluminum Case

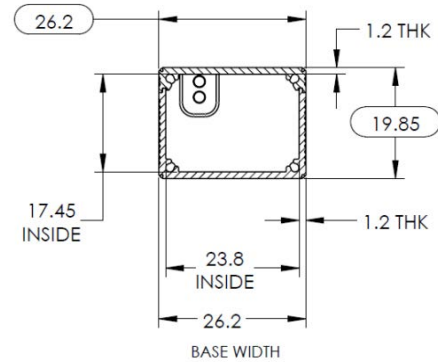
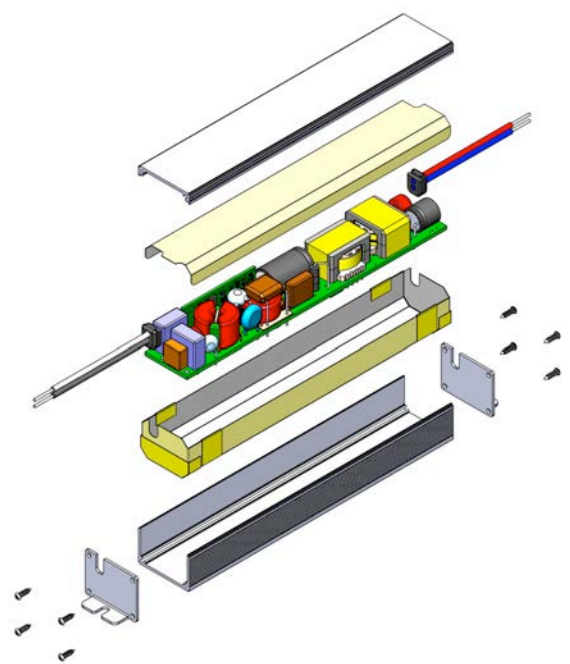

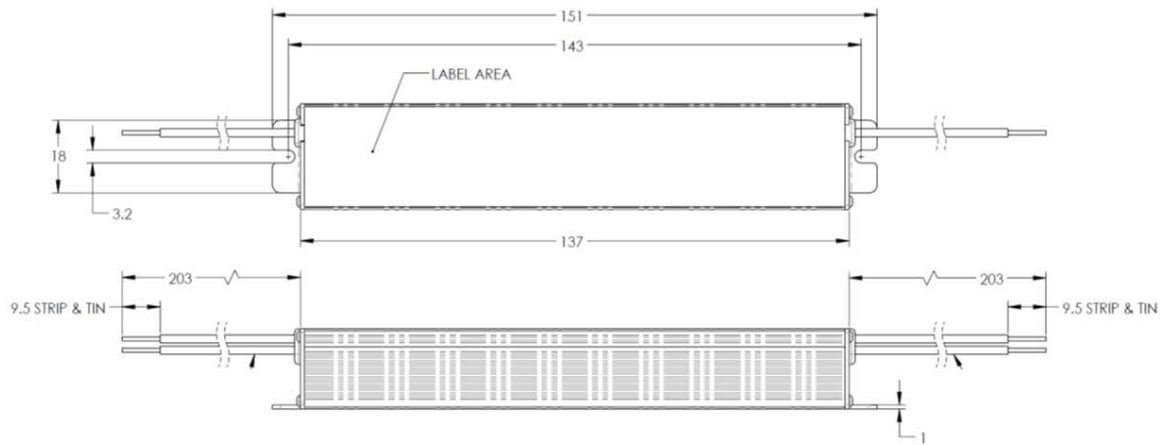

Previous
VLM100
Extruded
Aluminum
Case

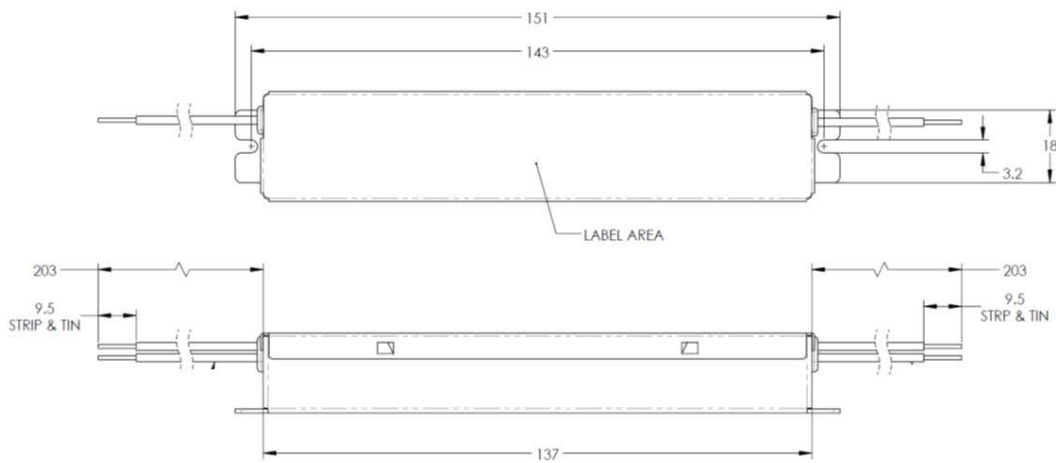
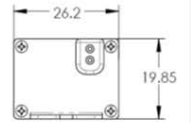

New
VLM100
Sheet
Metal
Aluminum
Case

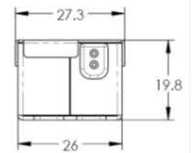

NEW VLM60/40 Sheet Metal Aluminum Case

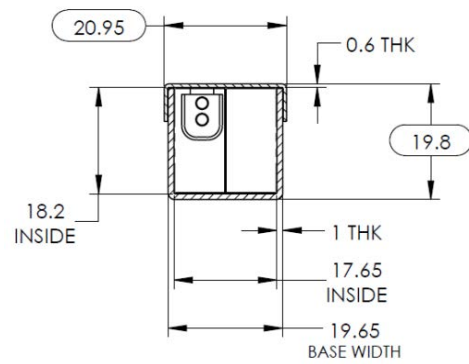
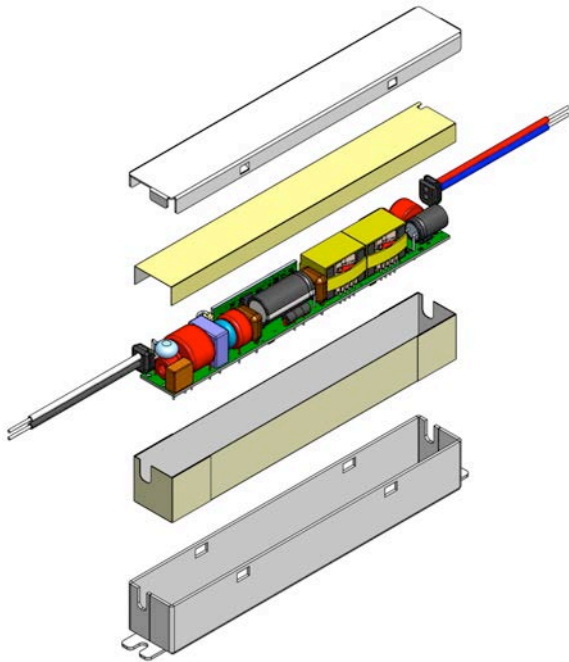

PREVIOUS VLM60/40 Extruded Aluminum Case

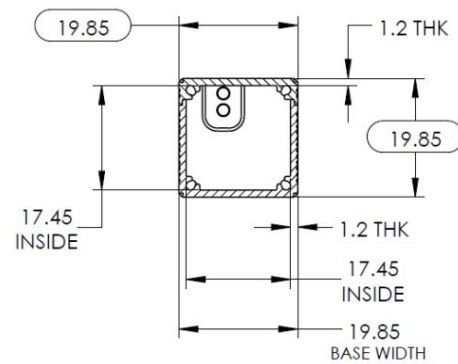
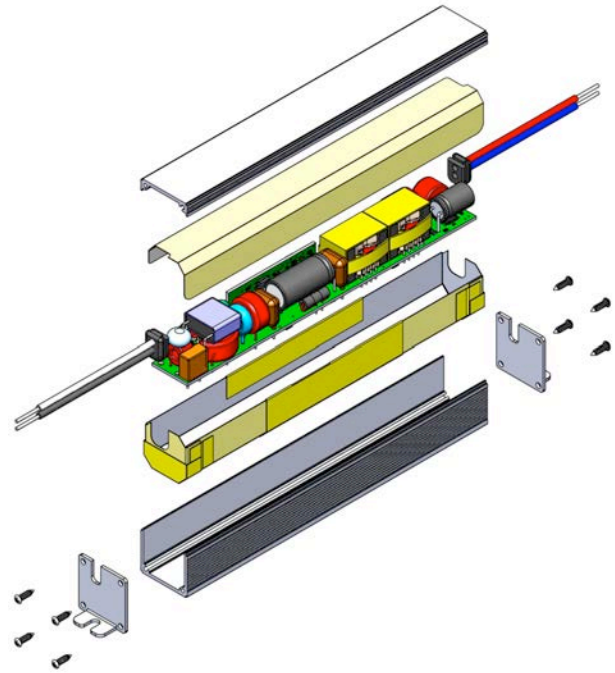

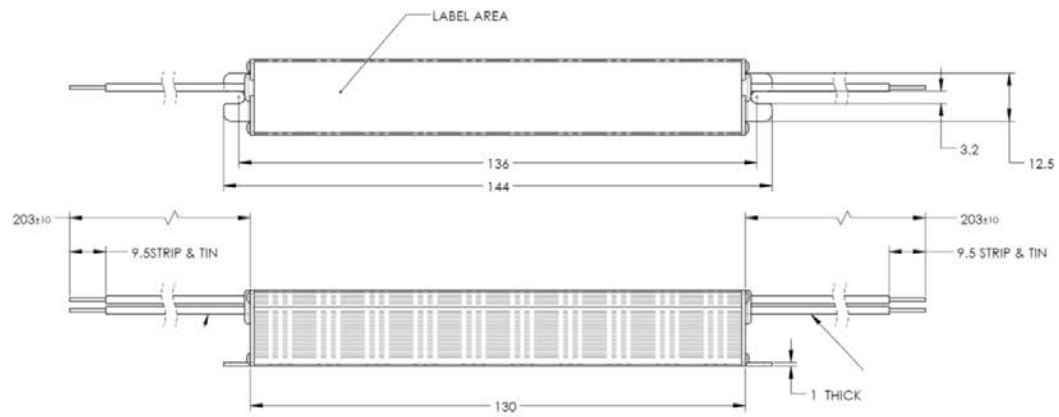

Previous
VLM60/40
Extruded
Aluminum
Case

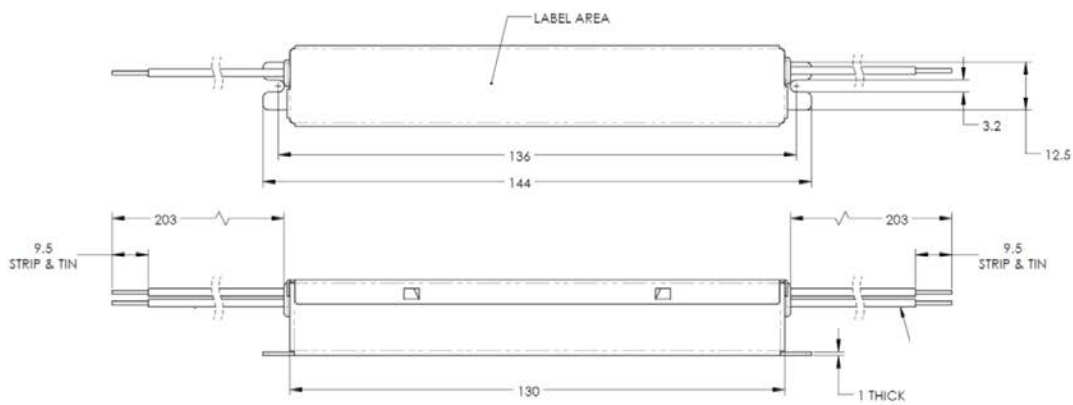
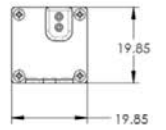

New
VLM60/40
Sheet
Metal
Aluminum
Case

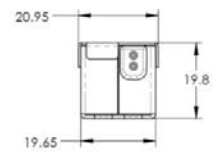

The summary of changes for the **side/bottom leads** VLM100-S Series case configuration are:

VLM100-S

- Overall footprint **length** remains the same at 137 mm
- Overall footprint **width** is 0.2 mm smaller at the bottom (26 mm whereas previously 26.2 mm), the top of the unit is 1.1 mm larger (27.3 mm whereas previously 26.2 mm)
- Overall footprint **height** remains the same at 23.85 mm
- Calculated lifetime remains greater than 50,000 hours at case temperature of 70°C for both 120Vac and 277Vac input

NEW VLM100-S Sheet Metal Aluminum Case

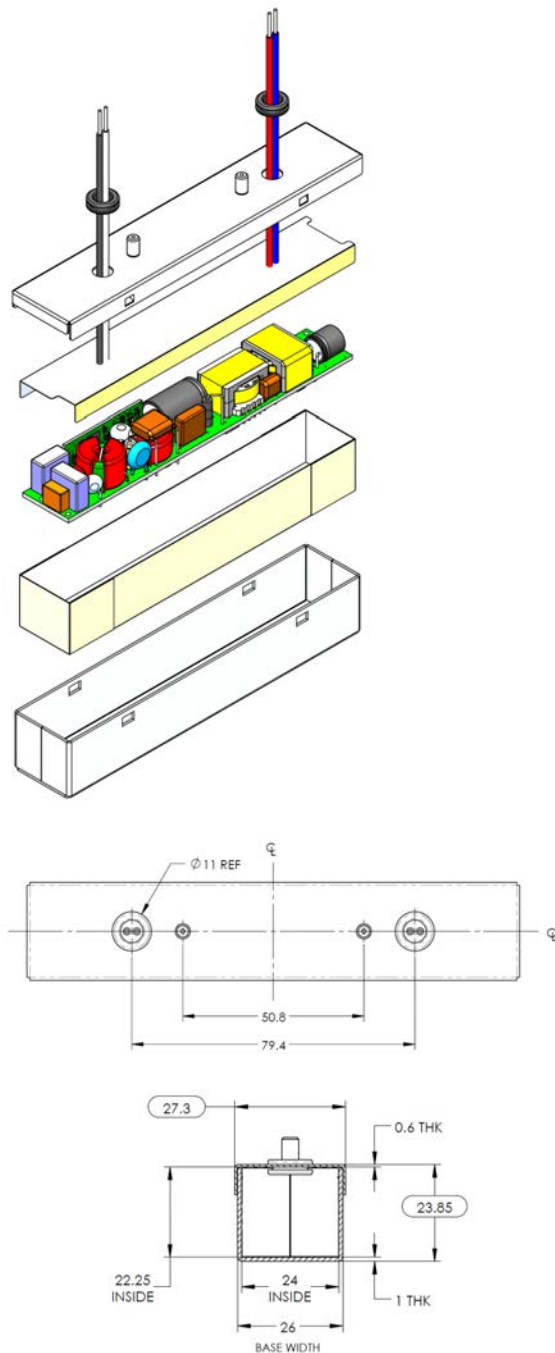

PREVIOUS VLM100-S Extruded Aluminum Case

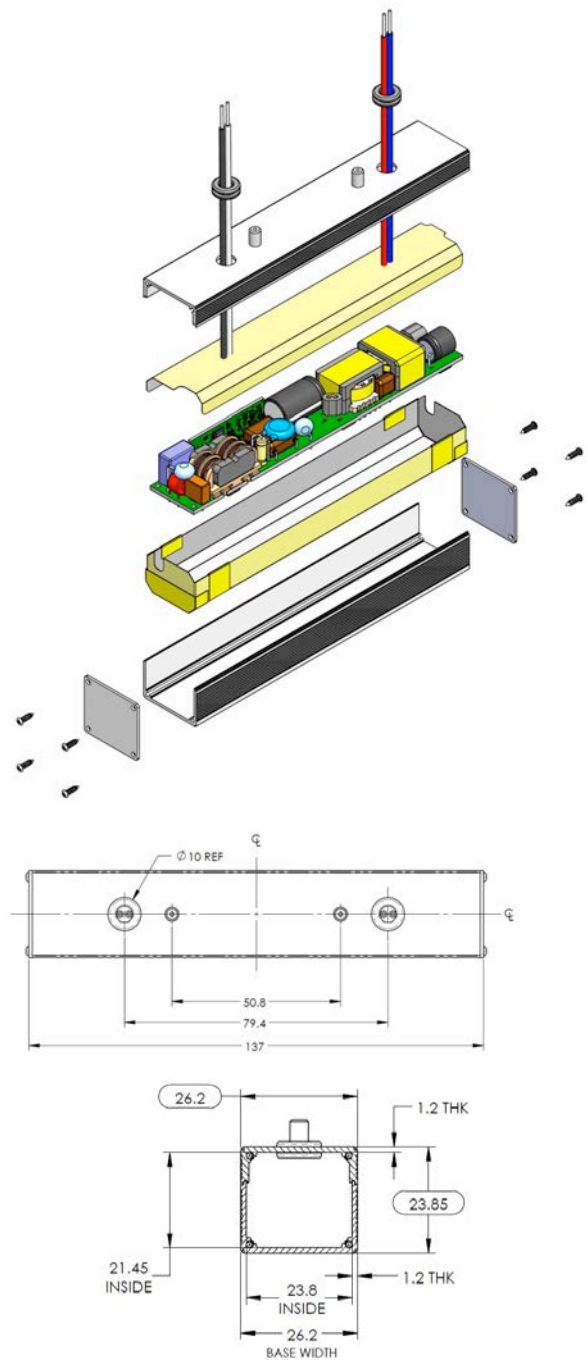

NEW VLM100-S Sheet Metal Aluminum Case

INPUT

2X - WIRE, 18AWG
105°C, STRANDED
N: WHITE
L: BLACK

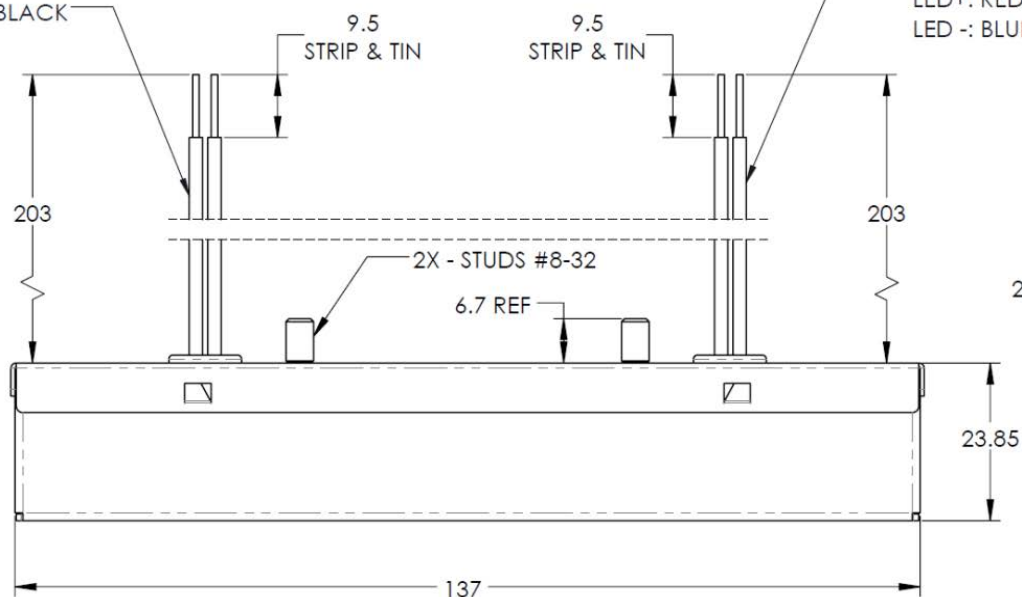

OUTPUT

2X - WIRE, 18AWG
105°C, STRANDED
LED+: RED
LED -: BLUE

PREVIOUS VLM100-S Extruded Aluminum Case

INPUT

2X - WIRE, 18AWG
105°C, STRANDED
N: WHITE
L: BLACK

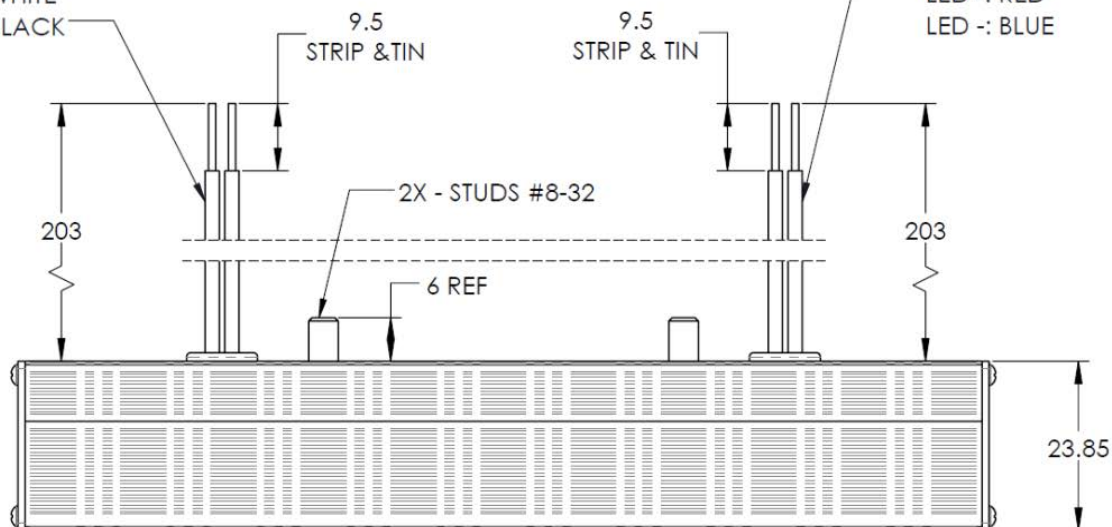

OUTPUT

2X - WIRE, 18AWG
105°C, STRANDED
LED+: RED
LED -: BLUE

The summary of changes for the **side/bottom leads** VLM60/40-S Series case configuration are:

VLM60-S / VLM40-S

- Overall footprint **length** remains the same at 130 mm
- Overall footprint **width** is 0.2 mm smaller at the bottom (19.65 mm whereas previously 19.85 mm), the top of the unit is 1.1 mm larger (20.95 mm whereas previously 19.85 mm)
- Overall footprint **height** remains the same at 23.85 mm
- Calculated lifetime remains greater than 50,000 hours at case temperature of 70°C for both 120Vac and 277Vac input

NEW VLM60/40-S Sheet Metal Aluminum Case

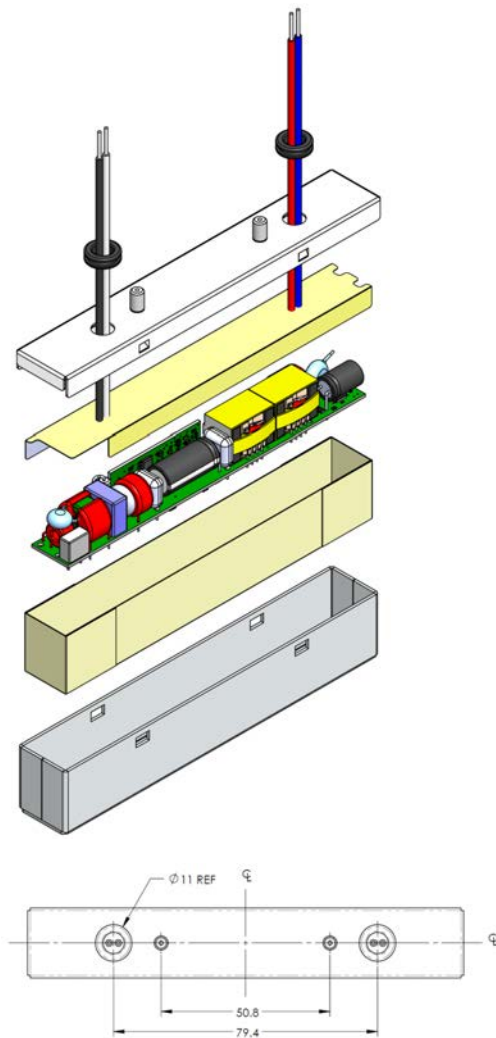

PREVIOUS VLM0/40-S Extruded Aluminum Case

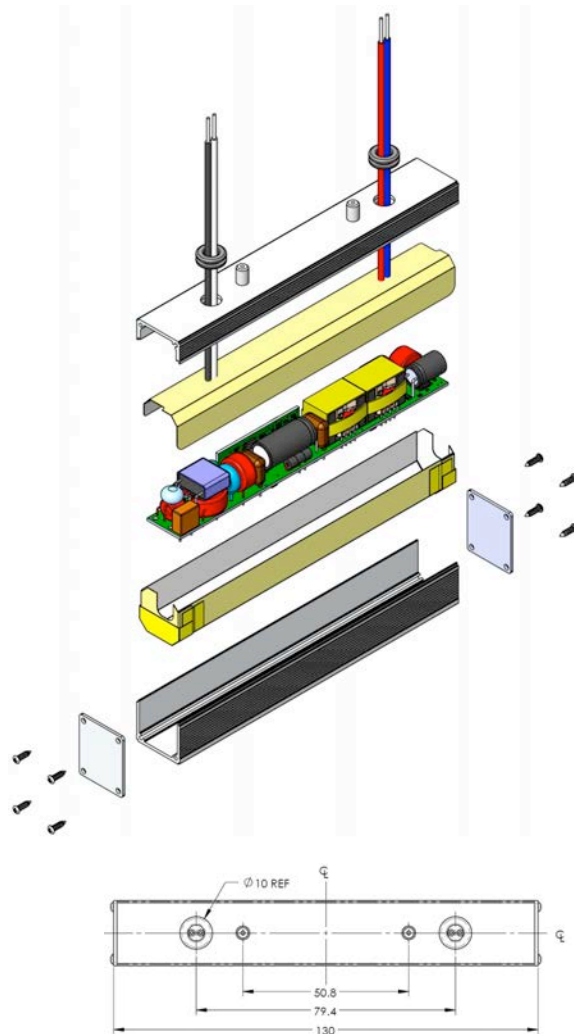

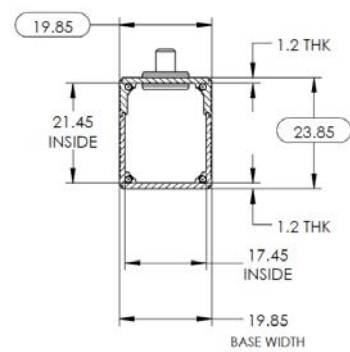
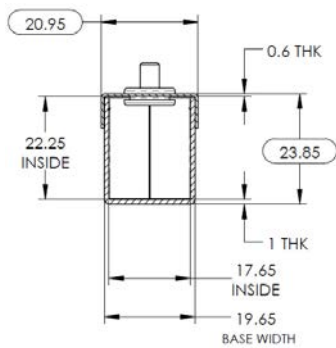

NEW VLM60/40-S Sheet Metal Aluminum Case

INPUT

2X - WIRE, 18AWG
105°C, STRANDED
N: WHITE
L: BLACK

2X - WIRE, 18AWG
105°C, STRANDED
LED+: RED
LED -: BLUE

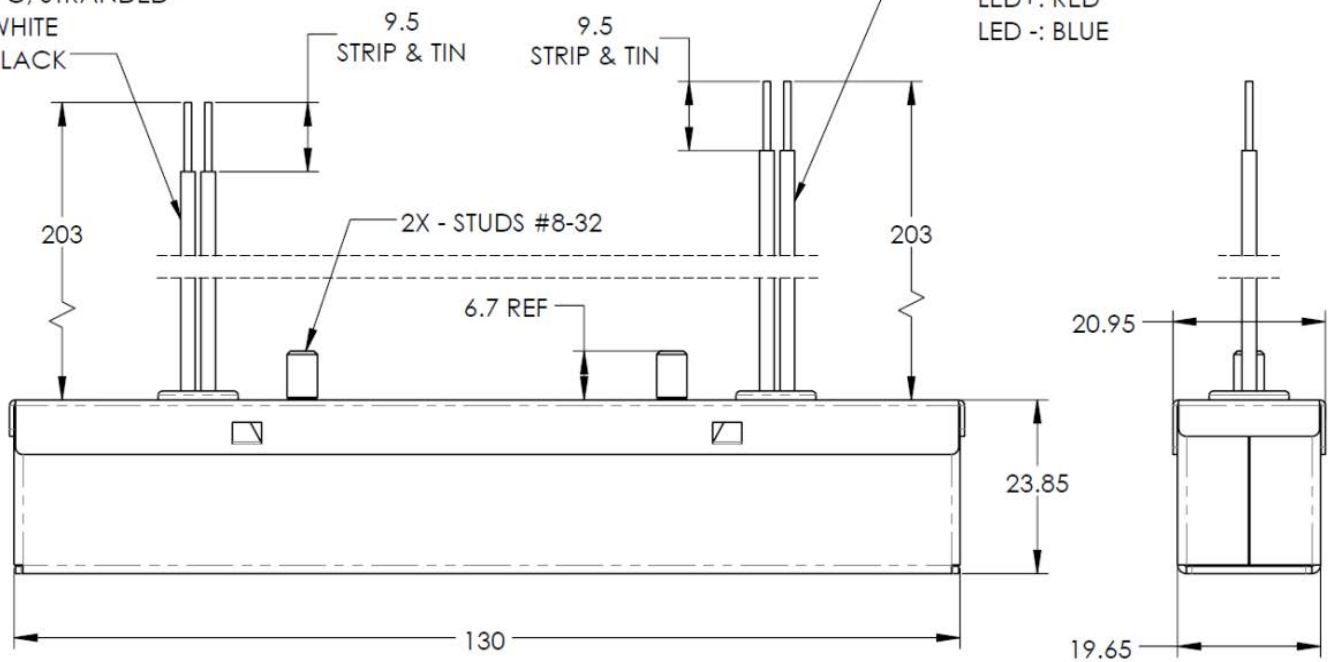

PREVIOUS VLM60/40-S Extruded Aluminum Case

INPUT

2X - WIRE, 18AWG
105°C, STRANDED
N: WHITE
L: BLACK

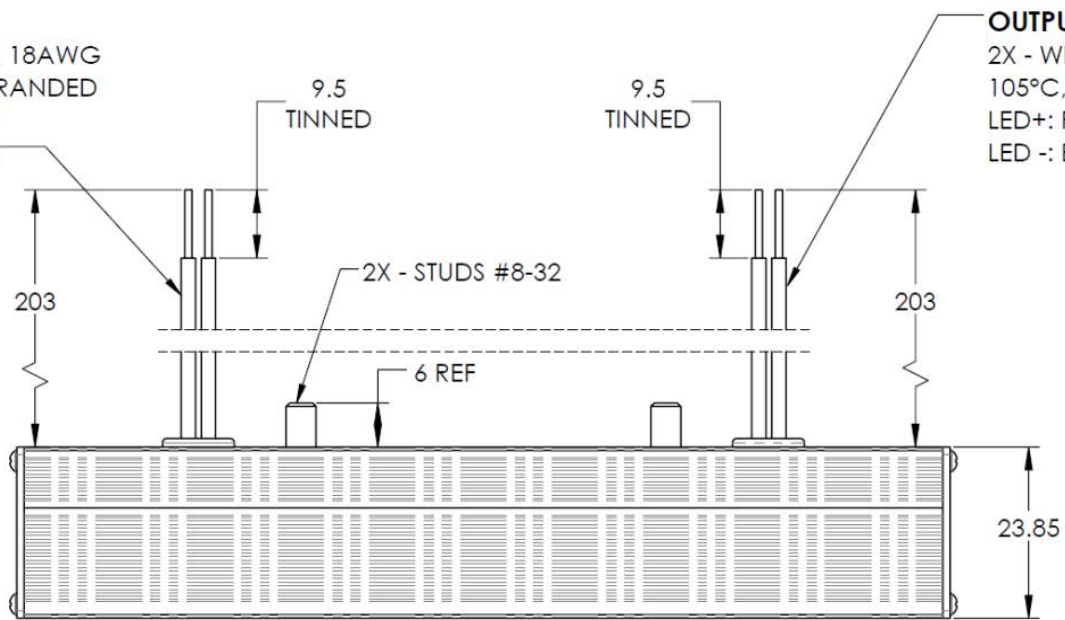

OUTPUT

2X - WIRE, 18AWG
105°C, STRANDED
LED+: RED
LED -: BLUE

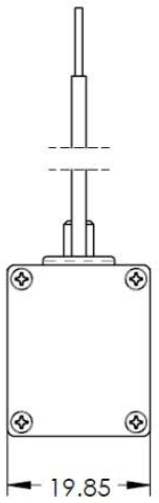

The summary of changes for the **terminal block** VLM100-T Series case configuration are:

VLM100-T

- Overall footprint **length** remains the same at 208.6 mm
- Overall footprint **width** is 0.2 mm smaller at the bottom (26 mm whereas previously 26.2 mm), the top of the unit is 1.15 mm larger (27.35 mm whereas previously 26.2 mm)
- Overall footprint **height** remains the same at 19.85 mm
- Calculated lifetime remains greater than 50,000 hours at case temperature of 70°C for both 120Vac and 277Vac input

NEW VLM100-T Sheet Metal Aluminum Case

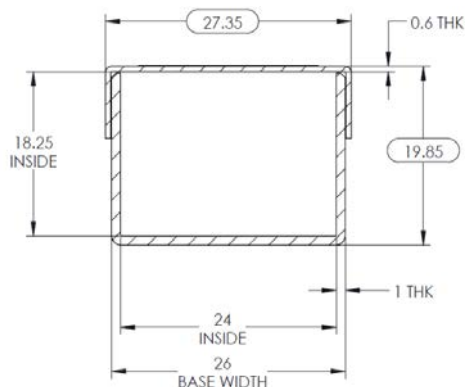
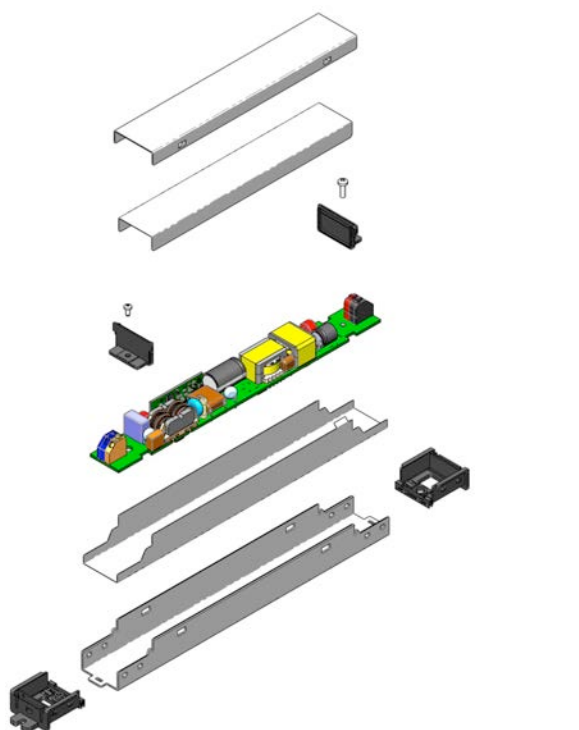

PREVIOUS VLM100-T Extruded Aluminum Case

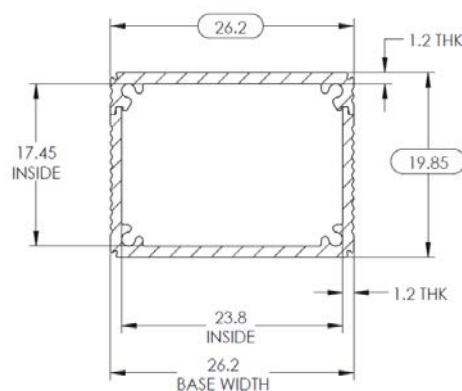
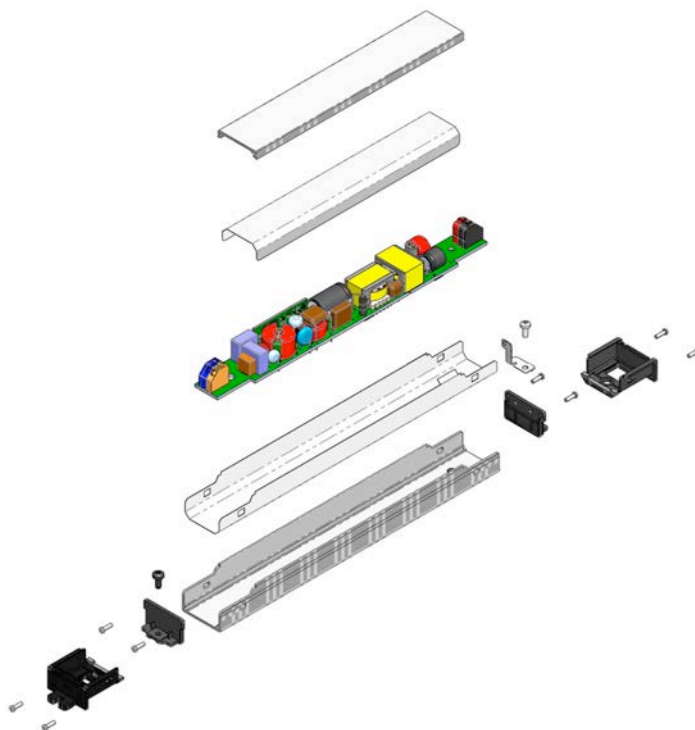

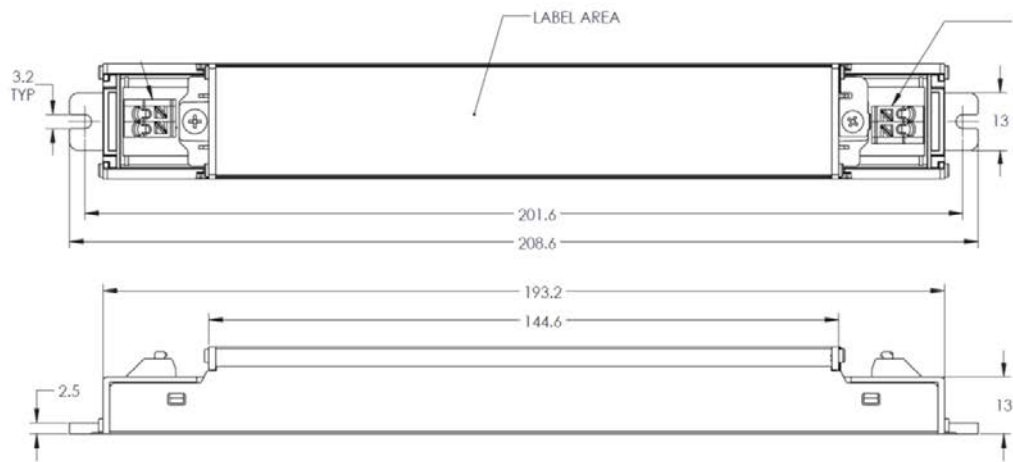

Previous
VLM100-T
Extruded
Aluminum
Case

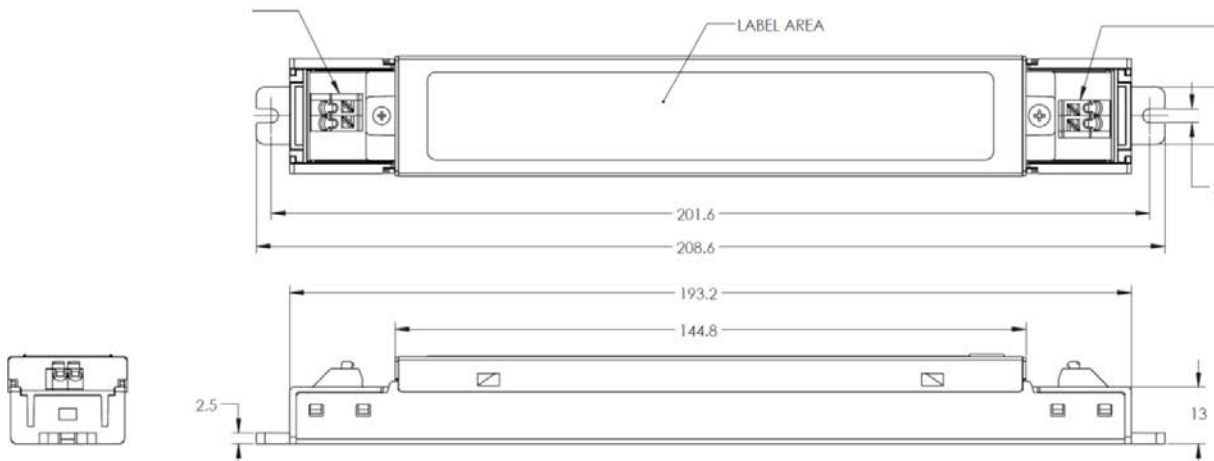

New
VLM100-T
Sheet
Metal
Aluminum
Case

The summary of changes for the **terminal block** VLM60/40-T Series case configuration are:

VLM60-T / VLM40-T

- Overall footprint **length** remains the same at 198.6 mm
- Overall footprint **width** is 0.2 mm smaller at the bottom (19.65 mm whereas previously 19.85 mm), the top of the unit is 1.15 mm larger (21 mm whereas previously 19.85 mm)
- Overall footprint **height** remains the same at 19.85 mm
- Calculated lifetime remains greater than 50,000 hours at case temperature of 70°C for both 120Vac and 277Vac input

NEW VLM60/40-T Sheet Metal Aluminum Case

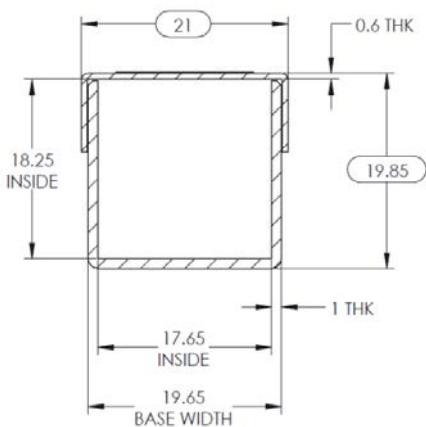
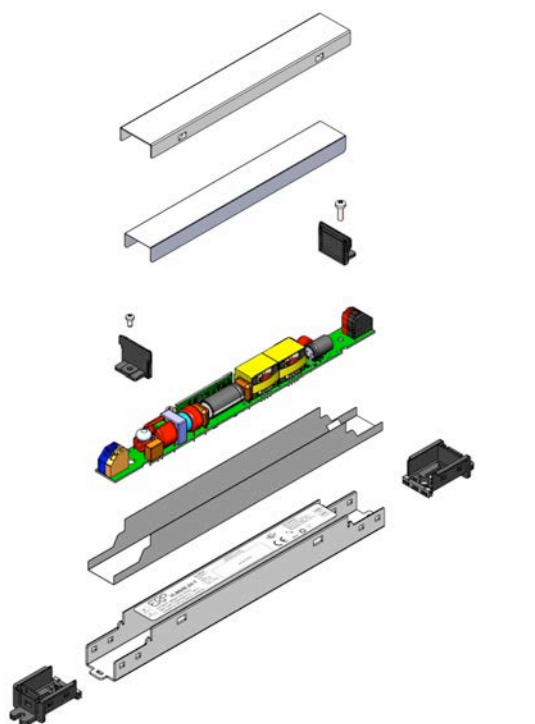

PREVIOUS VLM60/40-T Extruded Aluminum Case

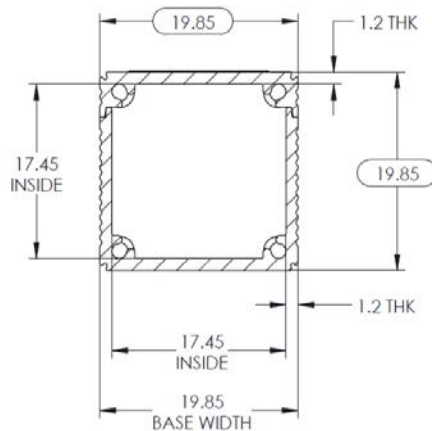
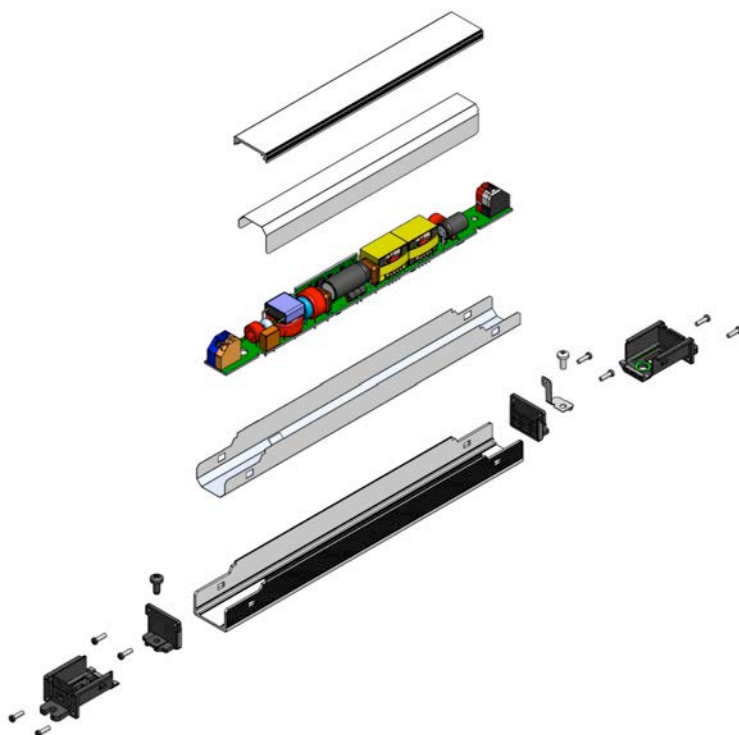

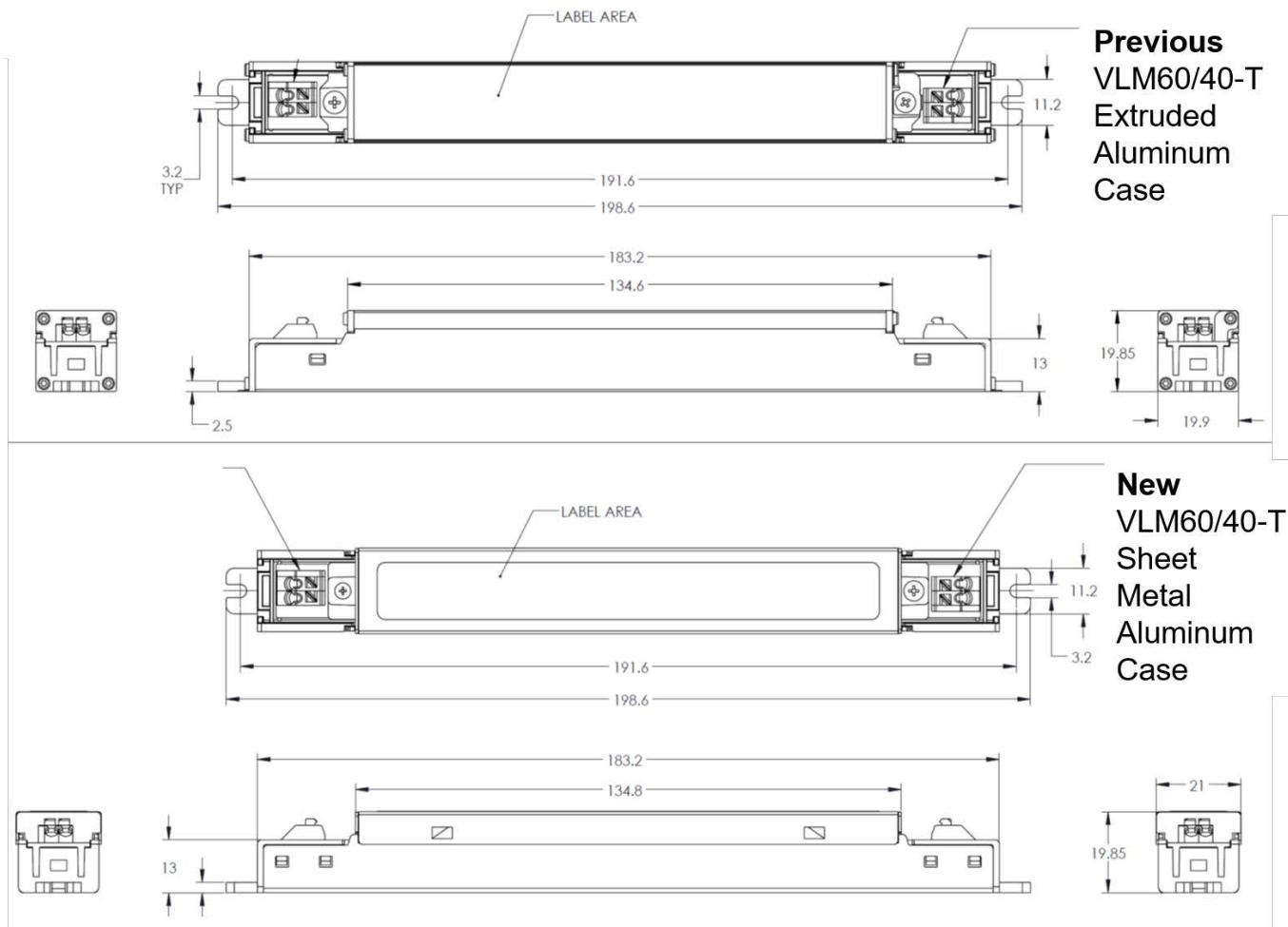

List of part numbers affected by this change

VLM60W-48-S	VLM100E-48-T	VLM40E-48-T
VLM60W-24-S	VLM100E-24-T	VLM40W-48
VLM60W-12-S	VLM100E-12-T	VLM40E-24-T
VLM40W-48-S	VLM100W-48	VLM40W-24
VLM40W-24-S	VLM100W-24	VLM40E-12-T
VLM40W-12-S	VLM100W-12	VLM40W-12
VLM100W-12-S	VLM60E-48-T	VLM60W-48
VLM100W-24-S	VLM60E-24-T	VLM60W-24
VLM100W-48-S	VLM60E-12-T	VLM60W-12